

# VADO VALA CONCEALED SHOWER VALVE WITH DIVERTER

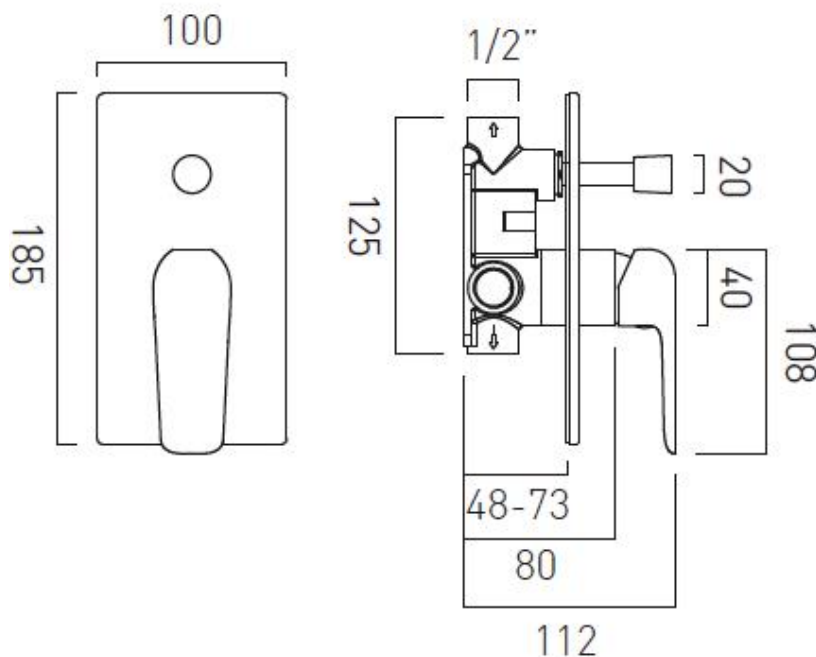

concealed 2 outlet shower valve with diverter  
single lever  
wall mounted  
with rectangular backplate  
ceramic cartridge CAR-K35A  
2 x 1/2" female inlets  
2 x 1/2" female outlets  
min-max wall mount 50-70mm  
minimum operating pressure 0.2 bar LP (shower)  
minimum operating pressure 1.5 bar MP (bath)

Vado Vala concealed shower valve  
with diverter 0.2 bar LP (shower)  
1.5 bar MP (bath) VAL-147



## DESCRIPTION:

concealed 2 outlet shower valve with diverter  
single lever  
wall mounted  
with oval backplate  
ceramic cartridge W-001-N35  
2 x 1/2" female inlets  
2 x 1/2" female outlets (one is blanked off)  
min-max wall mount 40-65mm  
minimum operating pressure 0.2 bar LP shower / 1.5 bar MP bath

## FINISH:

Chrome

## MINIMUM OPERATING PRESSURE:

0.2 bar LP (shower) 1.5 bar MP (bath)

## FLOW RATE AT 3.0 BAR FLOW PRESSURE:

Outlet 1: 22.3 l/m, Outlet 2: 21.5 l/m